

SME Digital Acceleration Series

CITA

Facilitating ongoing
digitalization through
common data structures

SME Digital Acceleration Series

CitA

Working with Standards

06:06:2023

SME Digital Acceleration Series

CitA



**A manufacturer's
approach to Digital
Product Development**



Jonathan Rogers

Kingspan Group
BIM Manager

Bsc Architectural Technology
DIT: 2011 – 2015

MOLA Architecture
Architectural Technologist: 2015 – 2019

MSc Applied Building Information and Modelling
TUD: 2016 – 2019
Dissertation: The Post-Occupancy Digital Twin

Kingspan Group
BIM Manager: 2019 - Present



Jonathan Rogers

Kingspan Group
BIM Manager

Kingspan roles and responsibilities

- Business development
- Project management
- Content development
- Library management
- Data management
- Alignment with International BIM Standards
- Integration with Digital Team
- Business support
- Order processing
- BIM Bundle delivery
- Customer support

The Envelope



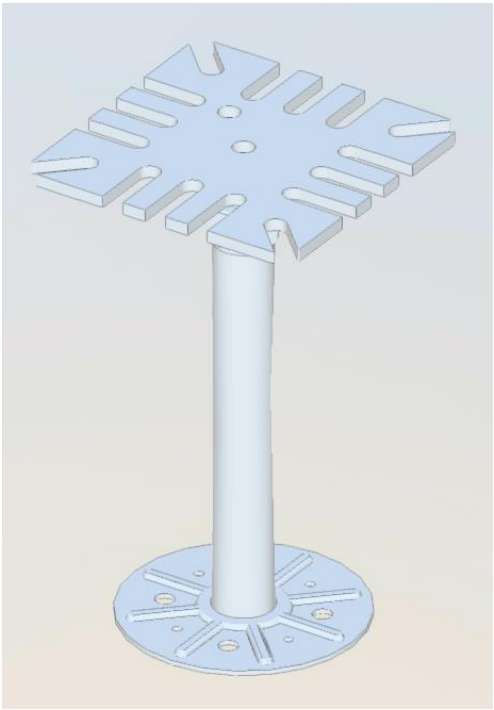
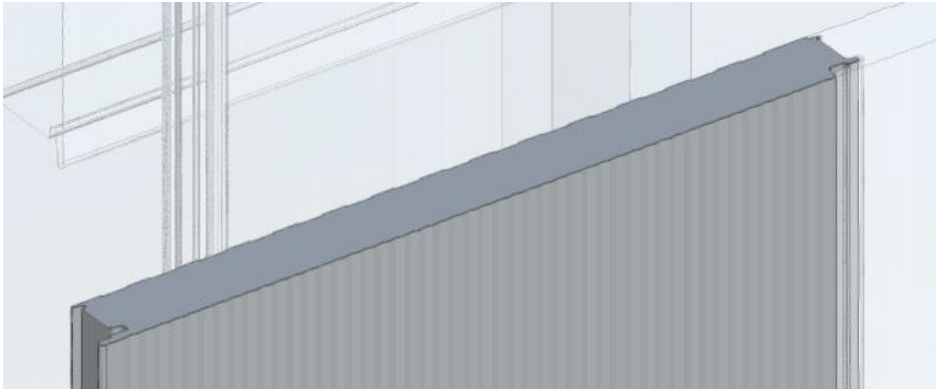
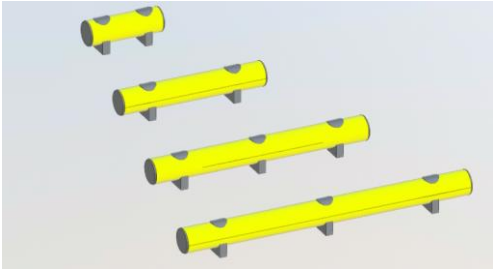
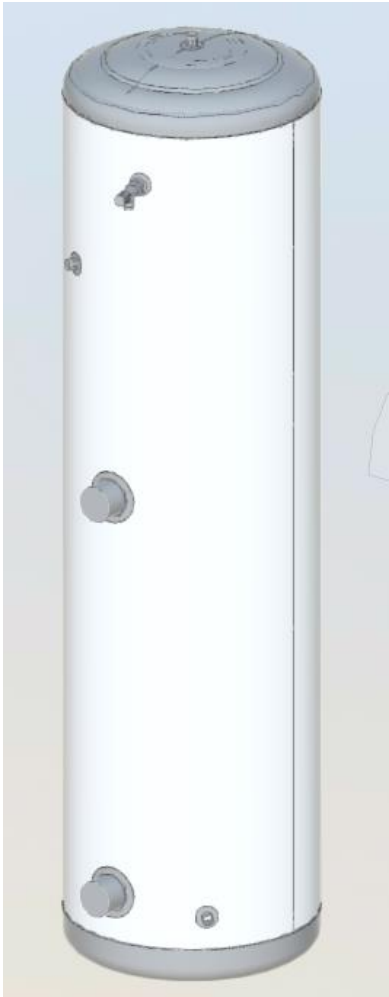

Level of Detail - Aligned with RIBA Plan of Work 2020

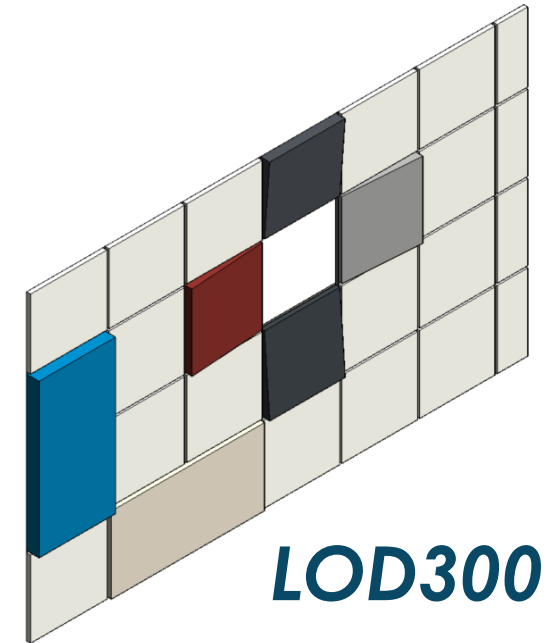
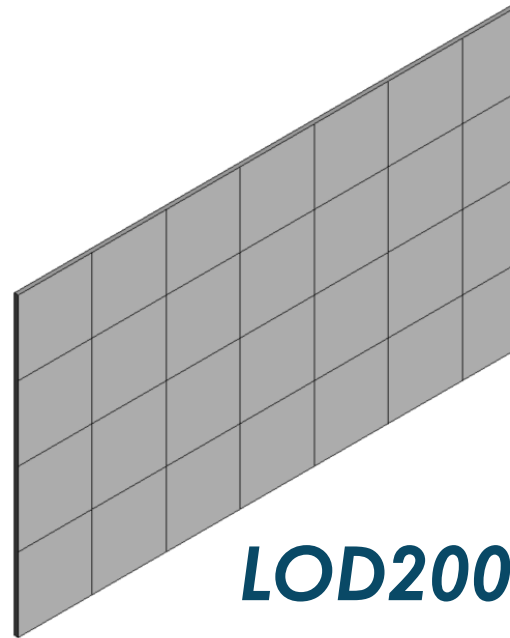

Level of Detail of BIM content
Developed for use in Autodesk Revit

- LOD200 – Concept Design
- LOD300 – Developed Design
- LOD400 – Detailed Design



UK BIM Standards

BS1192

PAS1192



International Organization for Standardisation

ISO19650-1 & 19650-2



PR1-XYZ-01-01-M3-A-0001_Doors



AUTODESK
CONSTRUCTION
CLOUD™

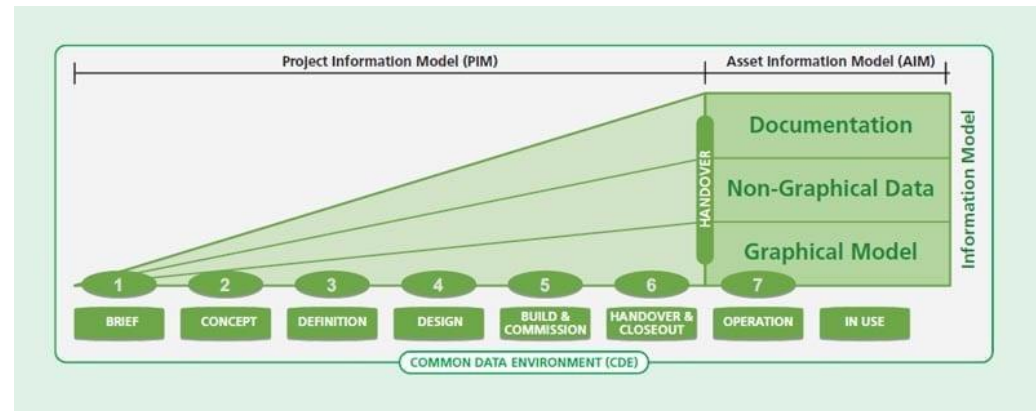

Autodesk Construction Cloud – Management & Distribution

- Aligned folder structure
- Single source of truth
- Collaboration
- Interoperability
- Familiarity & Education

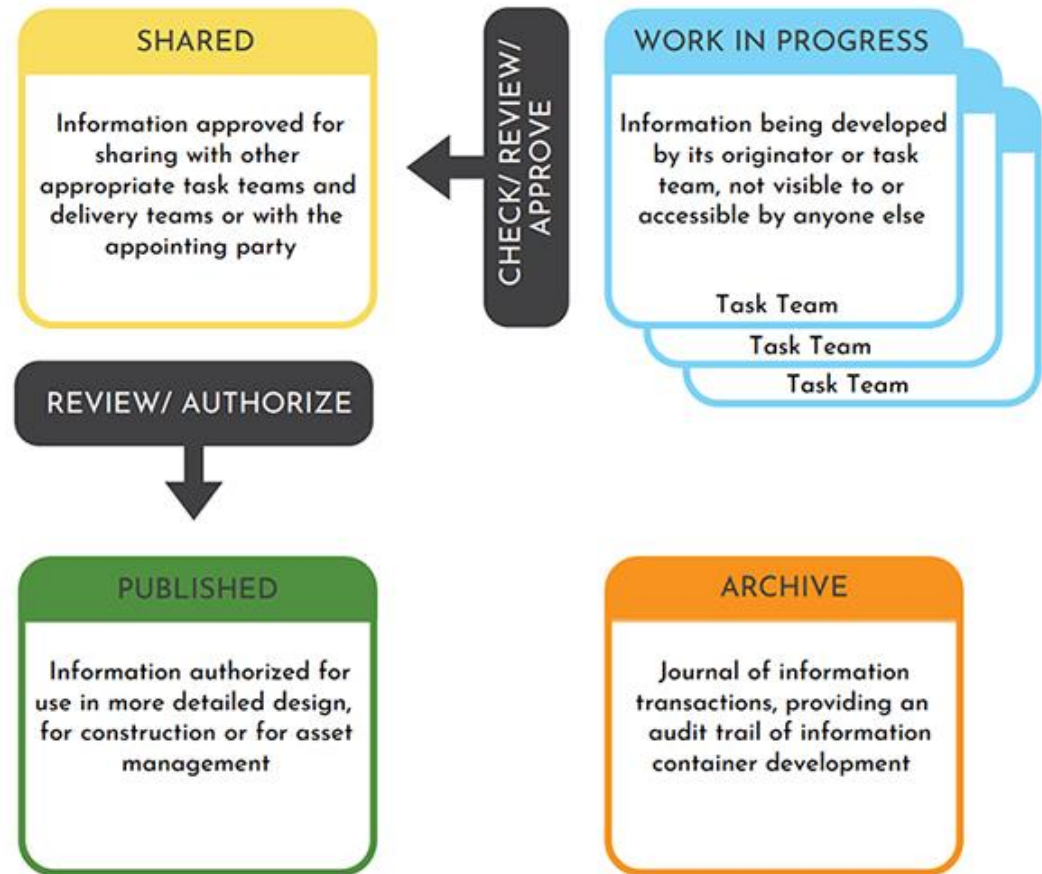

Project	Originator	Volume	Levels	Type	Role	Number	Description
---------	------------	--------	--------	------	------	--------	-------------



- 01 – KIP UKI
- 02 – MORIN
- 03 – KIP NA
- 04 – AWIP
- 05 – PAROC
- 06A – ISOCAB – EN
- 06B – ISOCAB - FR
- 07A – KIP MEXICO – EN
- 07B – KIP MEXICO – SP
- 08 – CLEANROOM
- 09 - COLDSTORE

01-----__

SME Digital Acceleration Series

CITA

Project	Originator	Volume	Levels	Type	Role	Number	Description
---------	------------	--------	--------	------	------	--------	-------------



KIP
KAF
KEW
KLA
KI

ISO
MOR
AWIP
VW
JI
ISO
PPS

01-KIP-----

Project	Originator	Volume	Levels	Type	Role	Number	Description
---------	------------	--------	--------	------	------	--------	-------------

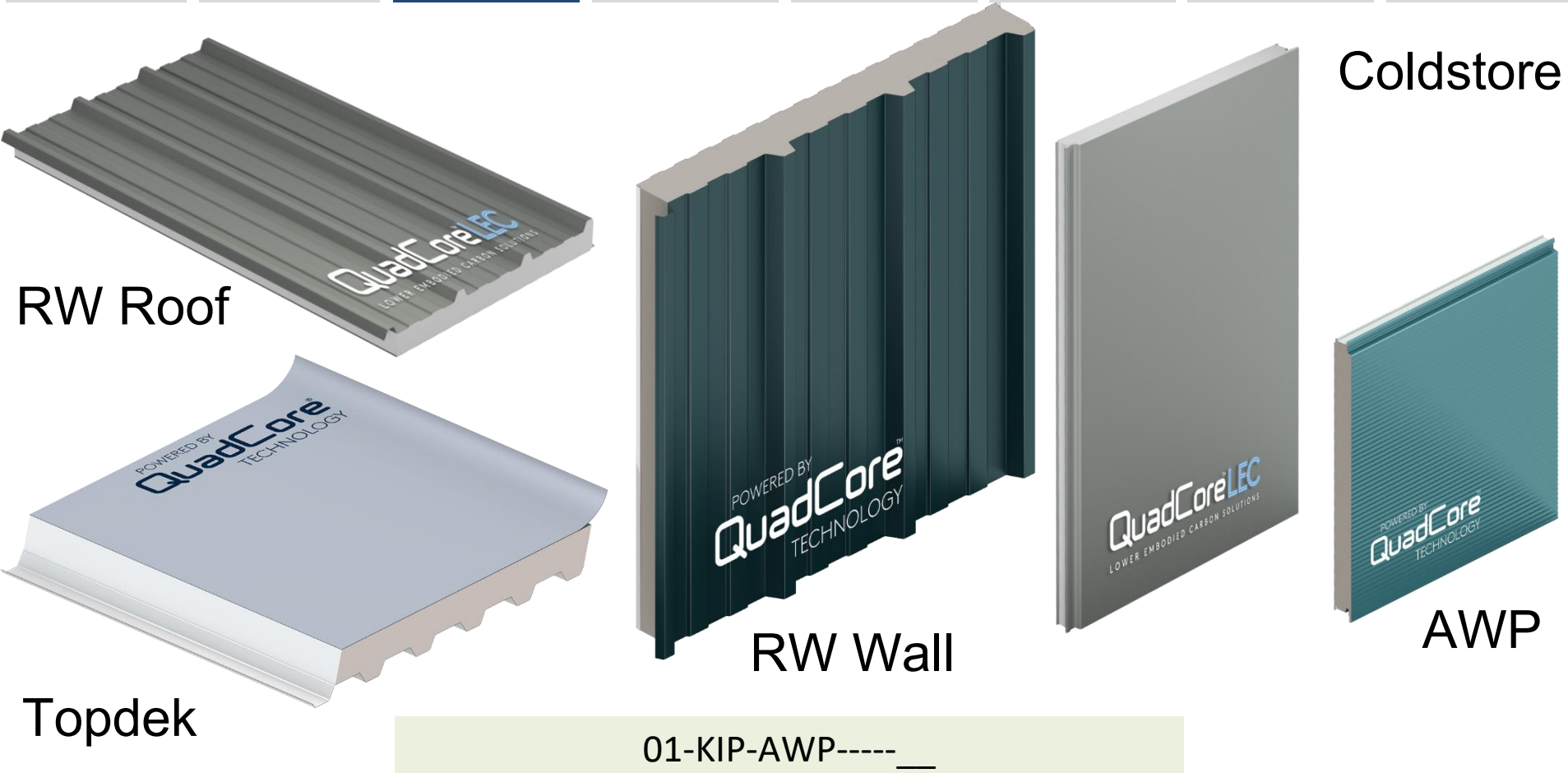

Coldstore

AWP

01-KIP-AWP-----

Project	Originator	Volume	Levels	Type	Role	Number	Description
---------	------------	--------	--------	------	------	--------	-------------

8.2.3 Standard codes for “levels” and “location”

The “level ~~text deleted~~” code should be two characters as follows:

- ZZ** Multiple levels
- XX No level applicable
- GF Ground floor
- 00 Base level of building (where ground floor is not appropriate) or linear assets

ZZ

9.2 Standard codes for types of information

The standard codes for file containers holding models and drawings the code should be exactly two characters as follows:

File types for drawings and models

Code	File Type
AF	Animation file (of a model)
CM	Combined model (combined multidiscipline model)
CR	Specific for the clash process
DR	2D drawing
M2	2D model file
M3	3D model file
MK	Model rendition file for other renditions, e.g thermal analysis etc.
VS	Visualization file (of a model)

M3

10.2 Standard codes for roles

The standard codes for file role should be exactly one character as follows:

- A Architect
- B Building Surveyor
- C Civil Engineer
- D Drainage, Highways Engineer
- E Electrical Engineer
- F Facilities Manager
- G Geographical and Land Surveyor
- H Heating and Ventilation Designer
- I Interior Designer
- K Client
- L Landscape Architect
- M Mechanical Engineer
- P Public Health Engineer
- Q Quantity Surveyor
- S Structural Engineer
- T Town and Country Planner
- W Contractor
- X Subcontractor
- Y** Specialist Designer
- Z General (non-disciplinary)

Y

01-KIP-AWP-ZZ-M3-Y--__

SME Digital Acceleration Series

CITA

Project	Originator	Volume	Levels	Type	Role	Number	Description
---------	------------	--------	--------	------	------	--------	-------------

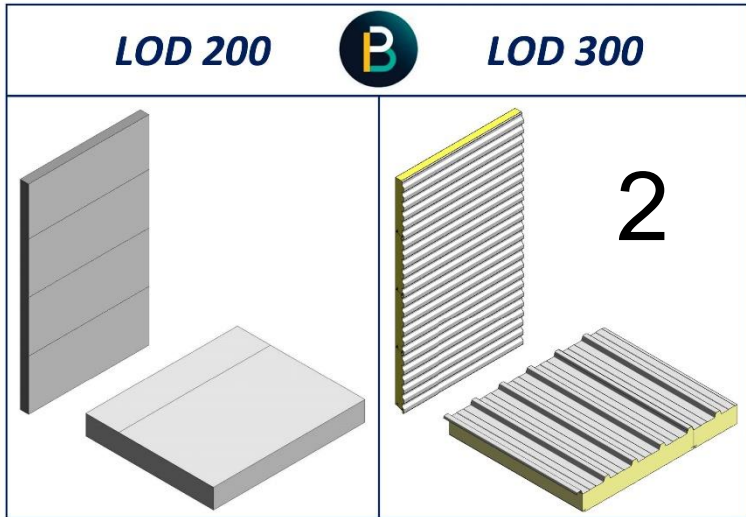

POWERED BY
QuadCore
TECHNOLOGY



0

01-KIP-AWP-ZZ-M3-Y-2001-__

01-99

Project	Originator	Volume	Levels	Type	Role	Number	Description
---------	------------	--------	--------	------	------	--------	-------------

Core Type

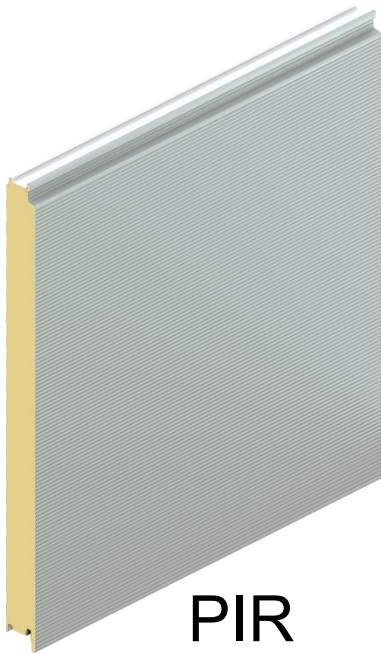

PIR

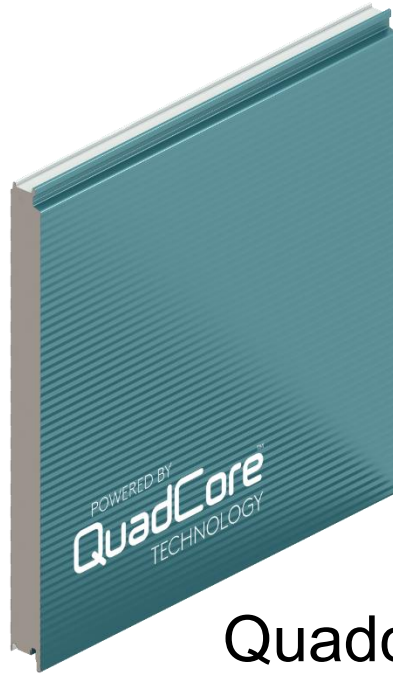

Quadcore



Quadcore
Lower
Embodied
Carbon

01-KIP-AWP-ZZ-M3-Y-2001-QC__

Project	Originator	Volume	Levels	Type	Role	Number	Description	Application
---------	------------	--------	--------	------	------	--------	-------------	-------------



Roof



Wall



Cleanroom

01-KIP-AWP-ZZ-M3-Y-2001-QC_Wall_

Project

Originator

Volume

Levels

Type

Role

Number

Description

Level Of
Detail

LOD 200



LOD 300

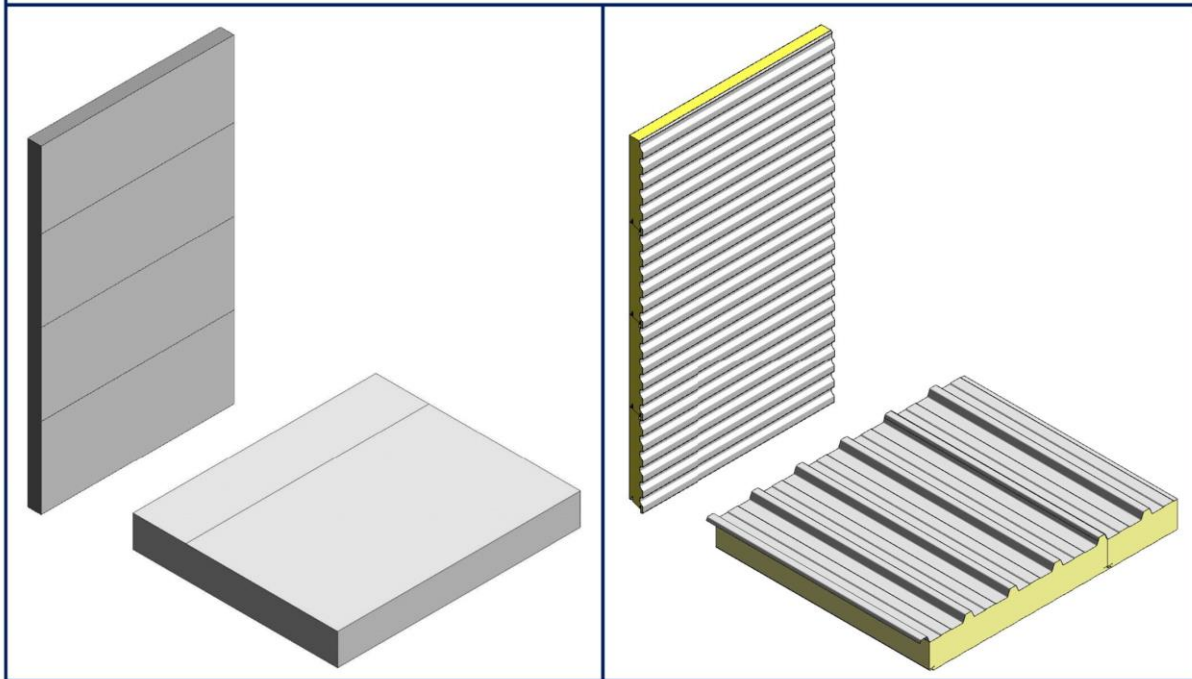

01-KIP-AWP-ZZ-M3-Y-2001-QC_Wall_LOD300

MODEL DISCIPLINE: Y - Specialist Manufacturer
 MODEL REFERENCE: 06-ISO-EN-ZZ-M3-Y-2001-QC_Wall_LOD300
 REVIT VERSION: Revit 2019.2

06-QC-Wall-LIN-RIB-LOD300



The installation of our process requires the use of silicone and butyl sealants in the interlocking joints of the panels. To be checked with your ISOCAB By Kingspan BIM Support.

Insulated Sandwich Panels

Isocab by Kingspan
 21, de Grande Synthèse
 3 Rue Charles Fourier
 Grande Synthèse
 F-59700
 T. +33
 Email: isocabimdesigner@kingspan.com

Insulated Sandwich Panels for Wall, Roof, Partition and Ceiling

isocab By Kingspan
 21, de Grande Synthèse - 3 Rue Charles Fourier, Grande Synthèse, F-59700
 Website: www.isocab.com
 Email: isocabimdesigner@kingspan.com

To be used only for the design of the building and the premises. Do not use to place orders.

Ask for a specific calculation note as soon as you design with an exterior color different from those of color group 1 according to standard EN14509

No .dwg or .doc files available on BIM360 allow fire resistance design. For specific fire resistance assemblies, consult ISOCAB By Kingspan

TO REQUEST AN ISOCAB BY KINGSPAN REVISION SPECIFICATION, PLEASE SCAN THE QR CODE BELOW AND COMPLETE THE ONLINE FORM



Rev	Description	Date
01	Revision 1	13/04/2022

CODE: 06-P01 AUTHORITY DESCRIPTION: Suitable for information

STATUS: 02 PURPOSE OF ISSUE: Shared (Non-contractual)

CLIENT: Isocab by Kingspan

PROJECT: 06-QC-Wall-LIN-RIB-LOD300

ISSUES: Project Overview

DESIGNED BY: Author CHECKED BY: Checker DATE: 13/04/2022

Task (if A1): ISOCAB By Kingspan - Project Number: 06-ISO-EN-ZZ-M3-Y-2001

ISOCAB By Kingspan - Drawing Number: ISOCAB-IND-QC-WALL-0001 REV: 01

This drawing is the property of Kingspan and may not be reproduced in any way without written consent from Kingspan.

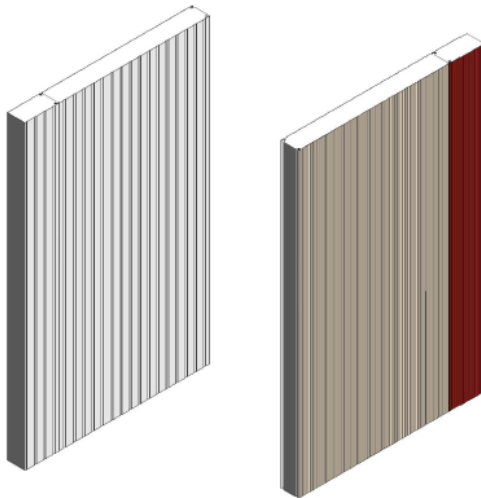

1 Interior Profile - Ribbed

2 Exterior Profile - Linea

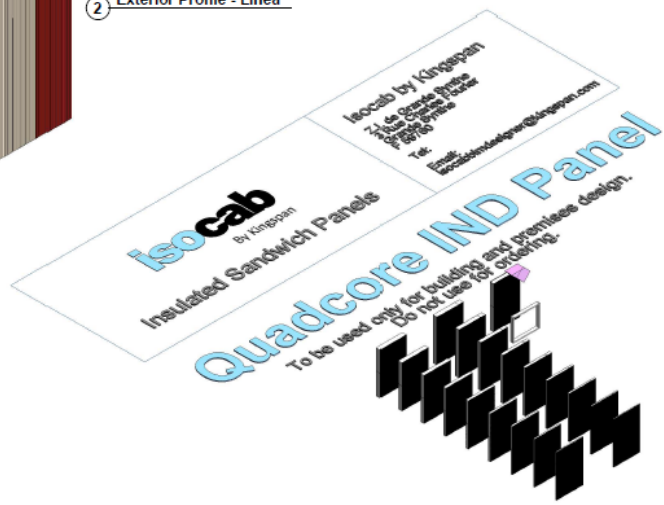

There are no .dwg or .doc files available on BIM360 for fire resistance design. For specific fire resistance designs, please consult ISOCAB By Kingspan

MODEL DISCIPLINE: Y-Specialist Manufacturer
 MODEL REFERENCE: GOALHOND-KGR-ZZ-ZZ-M3-Y-0002
 REVIT VERSION: 2020.2



1 3D External View



3 3D Internal View

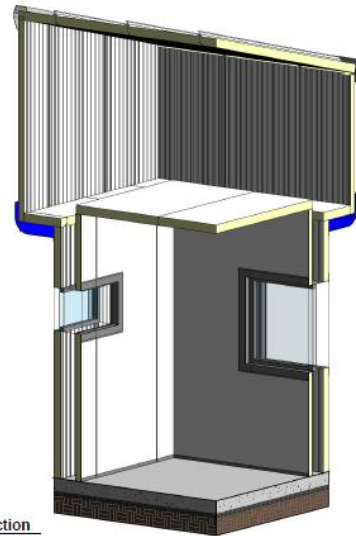

2 3D Building Section

Honduras Hospital

THE FOLLOWING MUST BE CONFIRMED BY THE PROJECT ENGINEER:
 - PRIMARY & SECONDARY STEELWORK DESIGNS (BASED ON PROJECT SPECIFIC LOADINGS)
 - RAINWATER DRAINAGE SYSTEM

3 NO. 4" X 4" DOWNSPOUTS REQUIRED ON EACH ROOF SLOPE, 9 NO. IN TOTAL

Insulated Roof & Wall Panels
 Kingspan Limited
 726 Somerset Drive, Duluth, FL, 32924, United States
 Tel: +1 870 436 3266
 Email: info@kingspan.com

FOR CONCEPTUAL DESIGN USE ONLY
 NOT TO BE USED FOR MANUFACTURING

TO REQUEST A KINGSKAN REVIT SPECIFICATION PLEASE SCAN THE QR CODE BELOW AND COMPLETE THE ONLINE FORM



Revit	Description	Date
1	Issued for Information	23/11/22
2	Issued for Information	26/11/22
3	Issued for Information	30/11/22
4	Issued for Information	16/12/22
5	Issued for Information	24/12/23
6	Issued for Information	14/02/23
7	Issued for Construction	27/03/23

CODE	SUITABILITY DESCRIPTION	
31-PT	Suitable for Coordination	
STATUS	31	
PURPOSE OF ISSUE	Sheet_Non-Contractual	
CUSTOMER	GOAL	
PROJECT	Honduras Hospital	
DRAWING	3D Views	
DRAWN BY	CHECKED BY	DATE
Author	Checker	27/03/23
SCALE (1:4)	ISO 15926 - PROJECT NUMBER	REV
	Project Number-ZZ-ZZ-DR-11-0001	7
KINGSKAN: DRAWING NUMBER:		
0001		

This drawing is the property of Kingspan and may not be reproduced in any way without written consent from Kingspan.

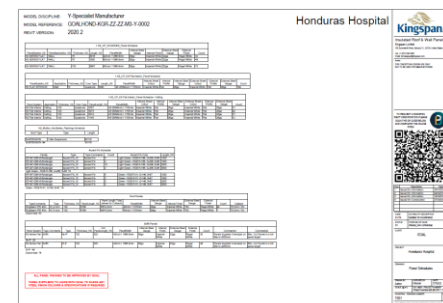
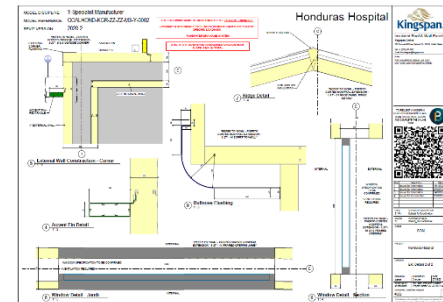
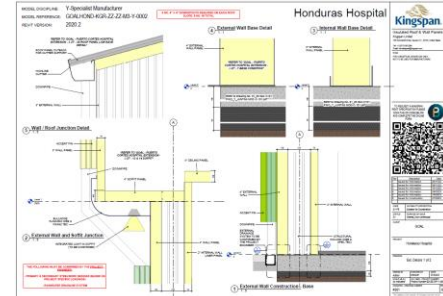

Looking forward – BIM Certification

BSI Kitemark for design and construction

The BSI Kitemark for design and construction provides independent and impartial evidence that you are delivering BIM projects.

In a competitive market, the BSI Kitemark enables you to differentiate your BIM projects and prove your credentials in relation to the industry recognised standard for the design and construction phase. Plus we assess your delivery of projects to contract requirements, your measurement and monitoring of client satisfaction against the delivery of a project, and the management of your supply chain, or your role within it.

It helps you to:

- Demonstrate your BIM maturity in the marketplace
- Embed collaboration on BIM projects across the supply chain
- Measure client satisfaction
- Gain a competitive edge when bidding for BIM tenders



Product Configurator aligned to ISO 19650

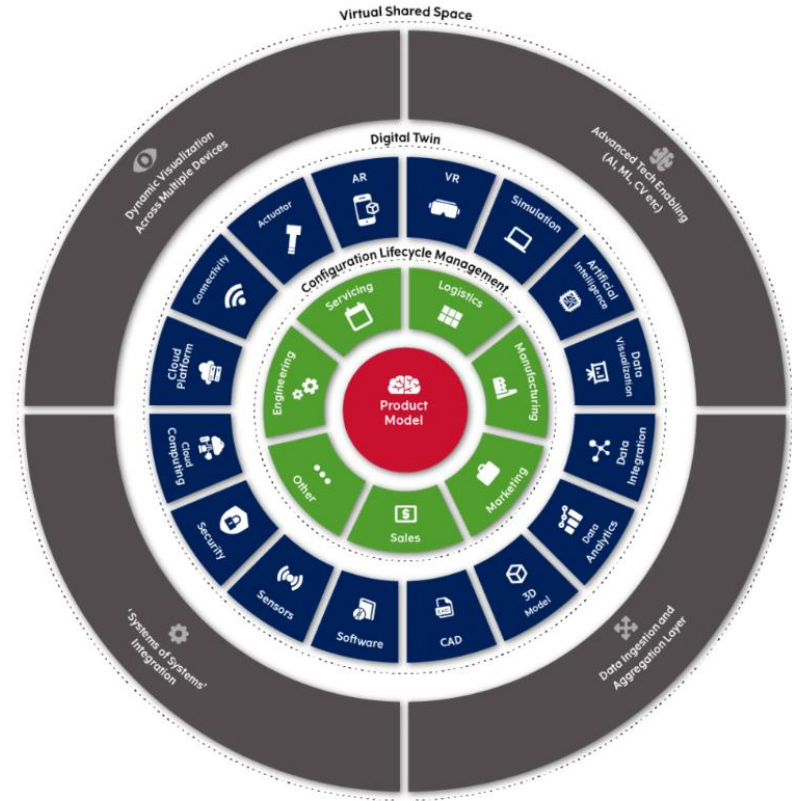
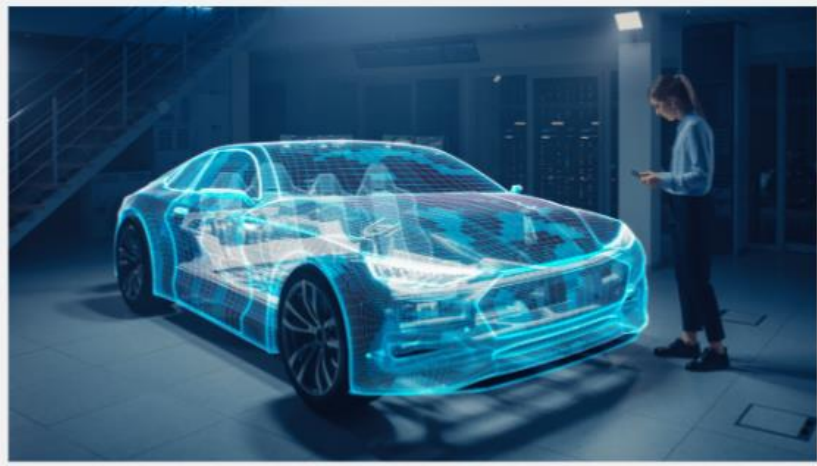

Scan to receive a
tailored BIM
Bundle for your
current project

All content delivered through
Autodesk BIM360



SME Digital Acceleration Series

CITA

**A manufacturer's approach to
Digital Product Development**

jonathan.rogers@kingspan.com

