

Gathering21

Construction Innovations
for Future Generations

CitA

WELCOME

to virtually, the most important
conference in Irish Construction
this year



5th CitA BIM Gathering Virtual Conference

21 - 23 September 2021

Gathering21

Construction Innovations
for Future Generations

CitA



BIM Manager at BIMake Sagl

Co-founder and Project Manager of CRArchitect with the application of Autodesk Revit and BIM as the main path for architectural projects since 2005.
Certified by ICMQ

BIM Architect at BIMake Sagl

Master of Architecture (Construction)
from BIM Department (Drawing to the future) of Politecnico di Torino.



BIMake
ad-hoc Building Information Modeling

Gathering21

Construction Innovations
for Future Generations

CitA

INTRODUCTION



5th CitA BIM Gathering Virtual Conference
21 - 23 September 2021



- The Importance and Necessity of BIM in Architecture and Construction.
- An Interdisciplinary Platform for Multidimensional Projects.
- Project Management and BIM



GBS	Geometry Breakdown Structure
WBS	Work Breakdown Structure
CBS	Cost Breakdown Structure
EBS	Equipment Breakdown Structure
OBS	Organization Breakdown Structure
RBS	Risk Breakdown Structure
MBS	Measurement Method Breakdown Structure
SBS	Specification Breakdown Structure
DBS	Drawing Breakdown Structure
PBS	Physical Breakdown Structure
FBS	Functional Breakdown Structure

- Breakdown of a Project
- The Necessity of Segregation in a Project in Its Different Aspects

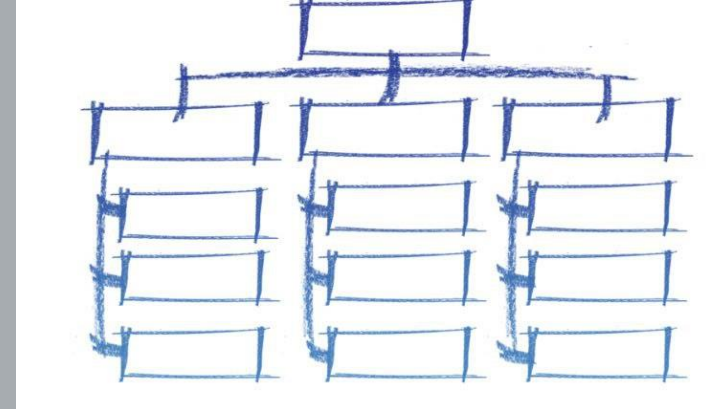

Work Breakdown Structure

- History and Definition
- The Role in the Project Management
- Relationship with the Other Breakdown Methods
- The Aim and Objectives of WBS
- Particular Advantages for Complex and Large Scale Projects

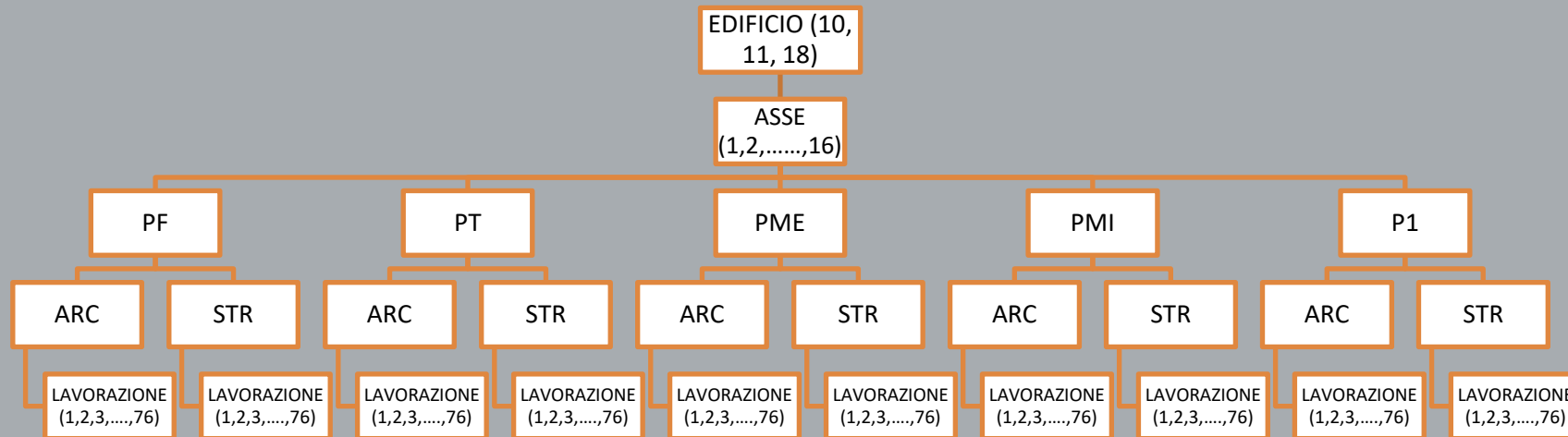



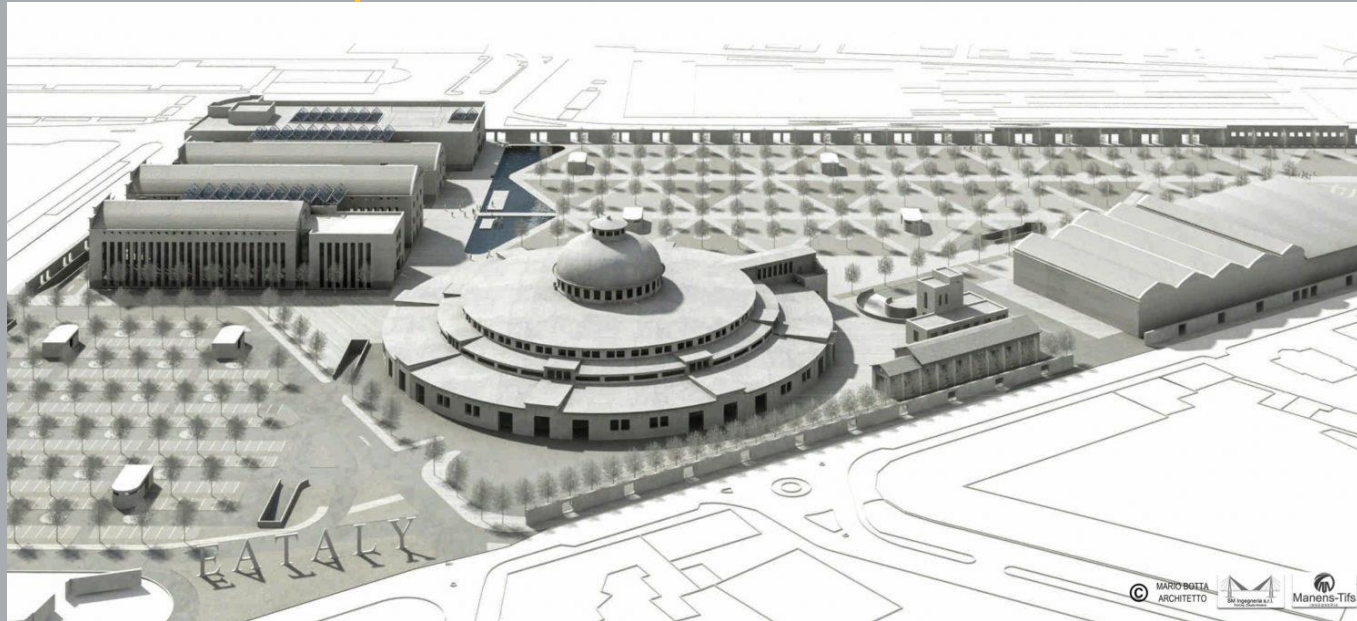

La Rotonda of Verona

- History and Definition of the Project
- A Use Change Project by Mario Botta
- The Mission of the Company: Cost Control beside Time and Construction and Work Scheduling

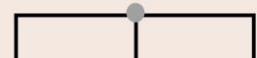

WBS Design Considering the Project Features

Subdivisions	Structure	Name	Level of Breakdown
4		Building	1
19		Slice	2
6		Level	3
3		Macro Activity	4
76		Micro Activity	5
274		Cost list	6

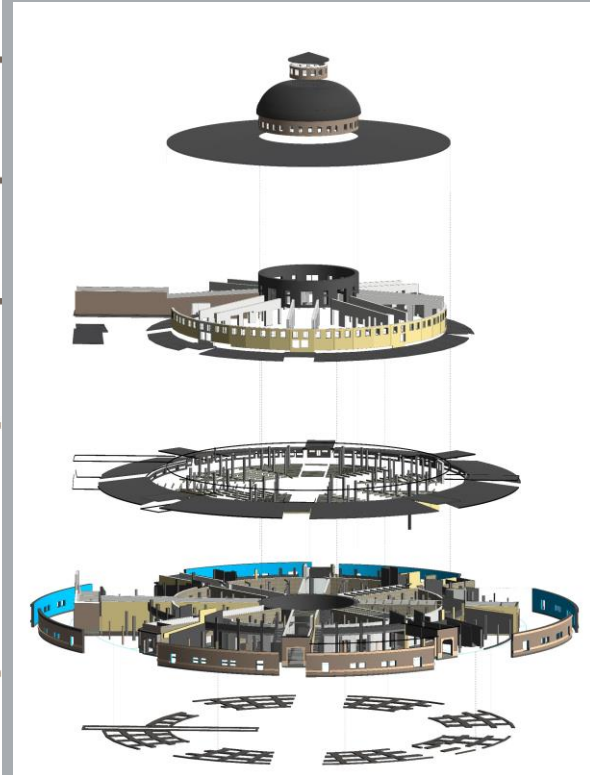

Conclusion

WBS in the BIM Platform

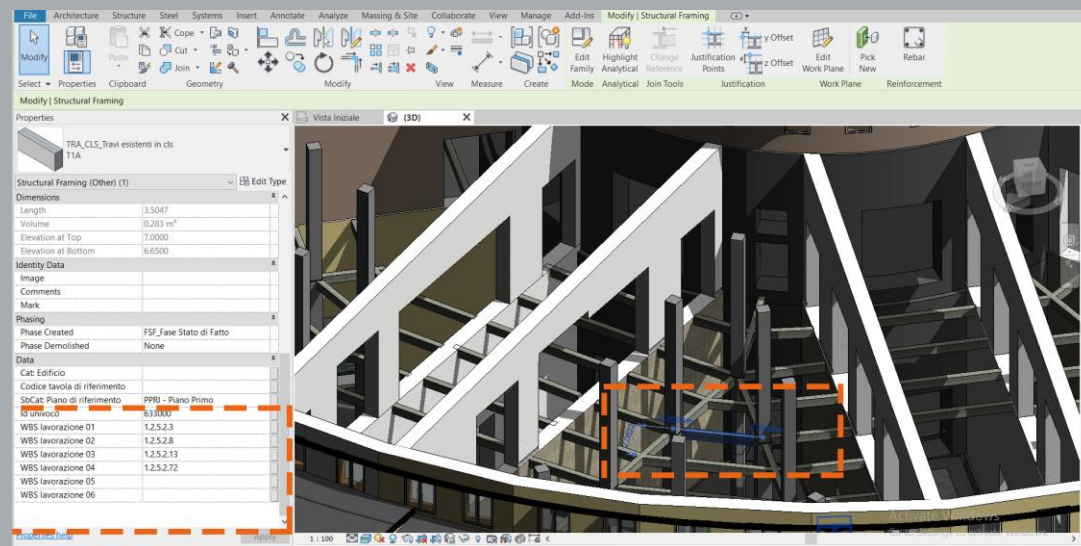

Data	
Cat: Edificio	
Codice tavola di riferimento	
SbCat: Piano di riferimento	PPRI - Piano Primo
Id univoco	633000
WBS lavorazione 01	1.2.5.2.3
WBS lavorazione 02	1.2.5.2.8
WBS lavorazione 03	1.2.5.2.13
WBS lavorazione 04	1.2.5.2.72
WBS lavorazione 05	
WBS lavorazione 06	

WBS 5	
A1002 - Reinterri	
A1003 - Demolizioni	
A1005 - Fondazioni speciali	
A1006 - Fondazioni	
A1007 - Ponteggi particolari	
A1008 - Lavorazione e posa ferro	
A1009 - Struttura c.a. per costruzioni civili tradizionali	
A1012 - Strutture in c.a. com m.o. a contratto	
A1013 - Strutture c.a. per manufatti speciali	
A1015 - Carpenteria metallica	
A1020 - Murature in blocchi cls portanti	
A1021 - Murature in blocchi cls non portanti	
A1022 - Murature in laterizio	
A1023 - Tramezzi e controtramezzi pref.	
A1024 - Finiture di facciata	
A1025 - Coperture	
A1026 - Impermeabilizzazioni	
A1027 - Opere da lattoniere	
A1029 - Opere da fabbro	
A1030 - Opere in pietra artificiale	
A1031 - Rasature e intonaci interni	
A1032 - Controsoffitti e pareti mobili	
A1033 - Infissi esterni	
A1035 - Infissi interni	
A1037 - Vetri	
A1038 - Sottofondi e vespai	
A1039 - Pavimenti	
A1040 - Rivestimenti	
A1041 - Zoccolini	
A1042 - Coibenze e isolamenti	
A1043 - Verniciature - tinteggiature interne	
A1046 - Impianto idrico e scarichi	
A1048 - Impianto ascensori	

Thank you